

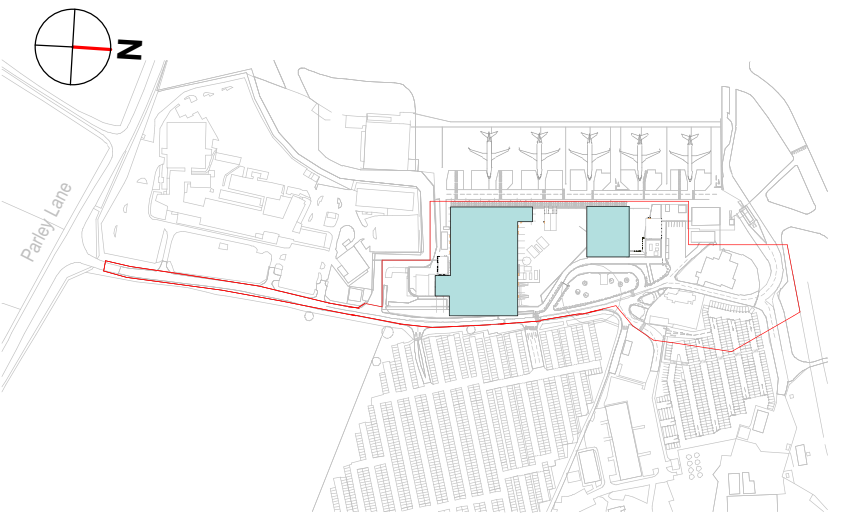

NOTE:
1. SAFETY IS A PRIORITY. IF YOU HAVE ANY CONCERN ABOUT SAFETY IN THE CONSTRUCTION OF THE TIME USE OF THE WORKS DESCRIBED, PLEASE RAISE IT IMMEDIATELY WITH THE PROJECT MANAGER.
2. DO NOT SCALE FROM THIS DRAWING.
3. ALL DIMENSIONS TO BE CHECKED ON SITE.
4. THE DRAWING SHALL BE READ IN CONJUNCTION WITH ALL OTHER ARCHITECTURAL, MECHANICAL, ELECTRICAL, SERVICE AND STRUCTURAL DRAWINGS, SPECIFICATION, SCHEDULES, REPORTS AND ASSOCIATED DOCUMENTS.
5. THE DRAWING SHOWN HEREIN IS PRELIMINARY AND SHALL NOT BE USED FOR CONSTRUCTION OR INSTALLATION PURPOSES.
6. THE DRAWING SHOWN HEREIN SHALL REQUIRE THE CONTRACTOR TO CONFORM WITH ALL THEIR SPECIALISTS AND INSTALLERS ALL ASPECTS OF THE WORKS COVERED BY THE CONTRACT. THIS SHALL INCLUDE BUT NOT BE LIMITED TO FULL COORDINATION WITH THE BUILDING AND ALL ELEMENTS THEREIN, LEAD TIME, PROGRAMME OF WORKS, CONSTRUCTION MATERIALS, FINISHES, ACCESS FOR INSTALLATION AND MAINTENANCE, INTEGRATION WITH OTHER ELEMENTS TO ALLOW FULL FUNCTIONALITY OF ALL ELEMENTS, GENERAL SURVEY OF THE SITE, ETC.
7. REFER TO RECORD AND/OR SURVEY DRAWINGS WHERE THEY EXIST TO DETERMINE FROM SITE SURVEY DETAILS OF EXISTING.



General notes
The existing drawings are assembled based on archival drawings, survey information, and site photographs. Survey information will represent the condition of the existing building at the time of the survey. Therefore, the existing drawings may not represent any recent changes or current ongoing works being carried out on site instructed outside of the works scope. Whilst all care will be taken to incorporate survey information into the drawings, no responsibility is taken for the accuracy of third party survey information.
This document represents the development of the terminal extension layout for RIBA Stage 2, incorporating instructions and consultant design information received to date. The information contained in this document may be further developed in order to align with selected sub-contractor design, for the purpose of obtaining final sign off on any outstanding design issues, leading to subcontractor design commencement and package procurement. All decisions, pricing and quantities based on this information should be considered provisional until verified by sign off or the design and specification.

Legend:

- Development boundary
- Existing buildings
- Temporary construction
- Proposed buildings
- New elements

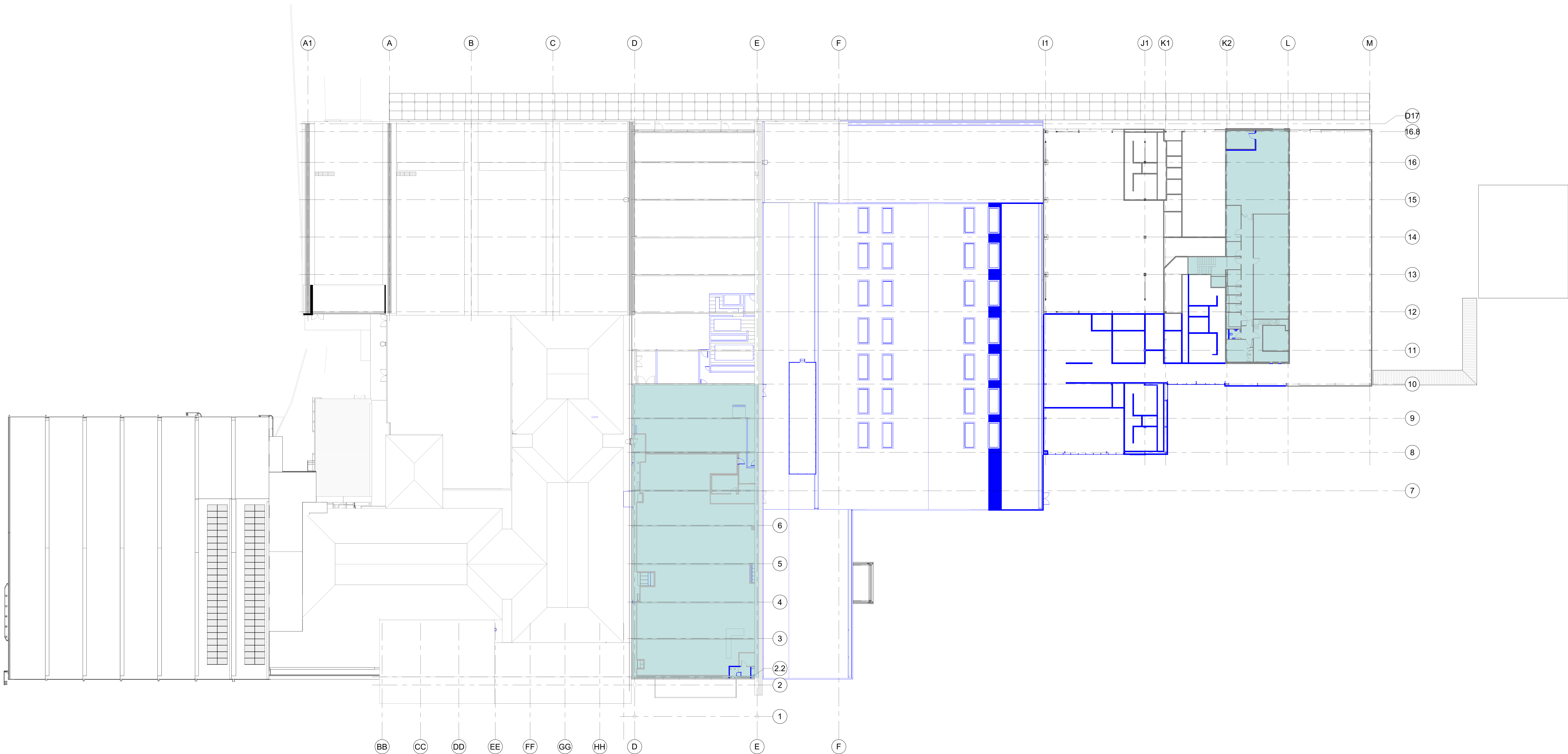

P1	JG	17/03/25	Planning Submission
Rev	Dm	Date	Description

This drawing supersedes:
Client
Bournemouth Airport
Regional & City
Airports

PASCALL + WATSON
The Warehouses 10 Black Friars Lane London EC4V 6EJ
T +44 (0)20 3837 2500 www.pascall.co.uk

Title
BOURNEMOUTH AIRPORT
TERMINAL EXTENSION
GENERAL ARRANGEMENT - L10
UPPER LEVEL - SUMMER 26 B

Project Name Bournemouth Expansion	Discipline Architecture	Originator Job No. 7279
Client Regional & City Airports	Drawing Originator Pascall + Watson	Purpose of Issue For Information
Drawn By R. An	Checked By J. Gil	Reviewed By T. Ward
Approved By J. Rogers	Scale As Indicated	Rev. P1
Drawing Number BOU-PAW-AA-L10-DGA-AR-201110	Rev. S2	

Note:
Contractors are responsible for the verification of all dimensions on site and the architect is to be informed of any discrepancy. Do not scale from the drawing. Use figured dimensions only. This drawing may contain Ordnance Survey Mapping and other data. © Crown Copyright and database right 2015. Ordnance Survey Licence number 10006115.